

## Modularity

Some of our system ankle joints feature a modular construction, which makes it possible to convert them among themselves quickly and easily by exchanging few system components and, in some cases, filing the system stirrup. In this online tutorial, you can find an overview of the system ankle joints and the steps necessary for conversion.

### FIOR & GENTZ

Gesellschaft für Entwicklung und Vertrieb  
von orthopädietechnischen Systemen mbH

Dorette-von-Stern-Straße 5  
21337 Lüneburg

☎ +49 4131 24445-0  
☎ +49 4131 24445-57

✉ [info@fior-gentz.de](mailto:info@fior-gentz.de)  
🌐 [www.fior-gentz.de](http://www.fior-gentz.de)



**FIOR & GENTZ**

Gesellschaft für Entwicklung und Vertrieb  
von orthopädietechnischen Systemen mbH

Dorette-von-Stern-Straße 5  
21337 Lüneburg

☎ +49 4131 24445-0  
☎ +49 4131 24445-57

✉ info@fior-gentz.de  
🌐 www.fior-gentz.de





- The system ankle joints NEURO VARIO 2, NEURO VARIO-CLASSIC 2, NEURO SWING, NEURO SWING 2, NEURO VARIO-SWING and NEURO VARIO-SPRING 2 are completely modular and can be converted among themselves.
- They differ in the cover plate with the mounted screw units/spring units.
- The cover plate with the mounted screw units/spring units has to be exchanged in order to convert the system joint.
- The production technique for reinforcing the orthosis as well as the assembly/lamination dummy are identical.

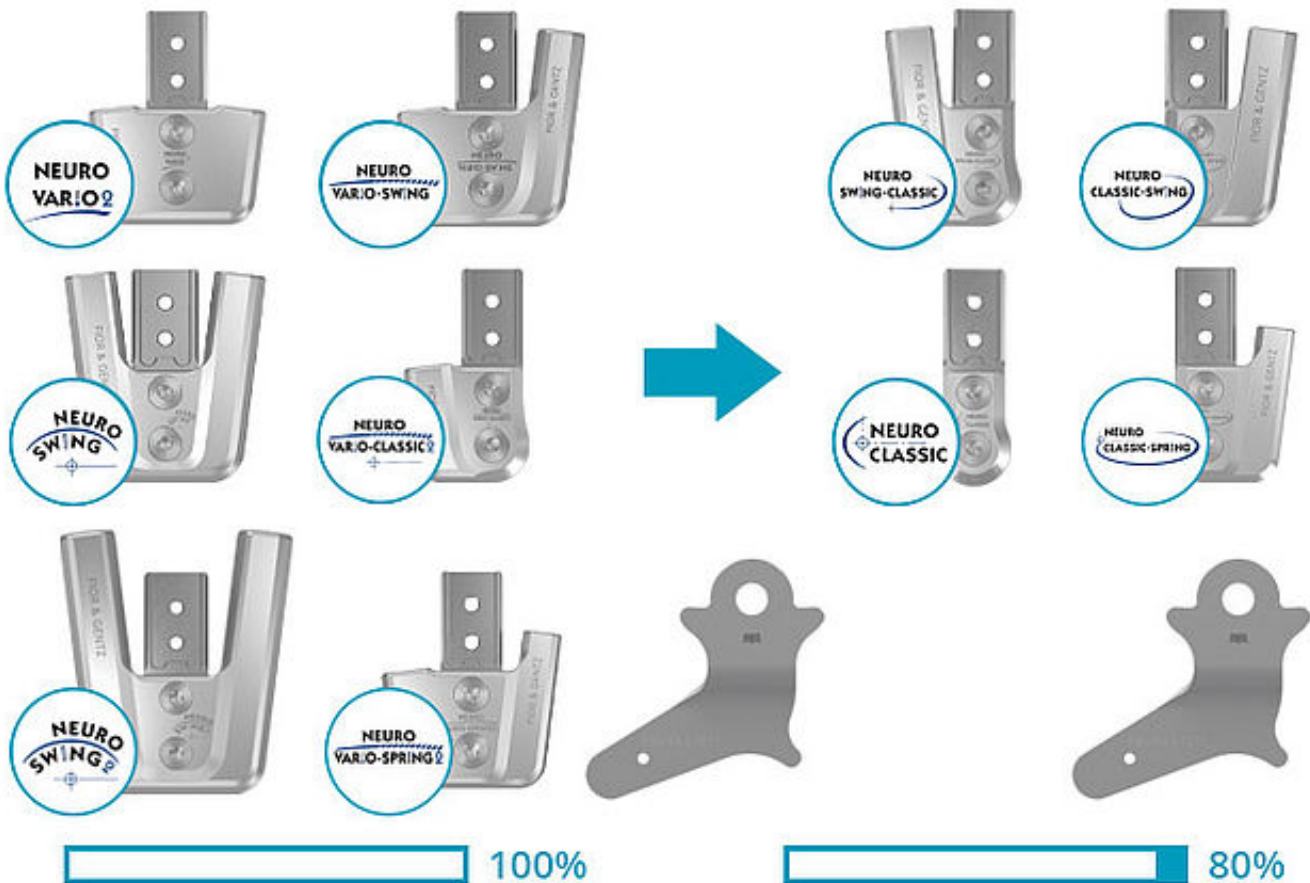

- It is also possible to convert the completely modular system ankle joints NEURO VARIO 2, NEURO VARIO-CLASSIC 2, NEURO SWING, NEURO SWING 2, NEURO VARIO-SWING and NEURO VARIO-SPRING 2 into NEURO SWING-CLASSIC, NEURO CLASSIC-SWING, NEURO CLASSIC andnd NEURO CLASSIC-SPRING.
- They differ in the cover plate with the mounted screw units/spring units and in the system stirrup.
- The cover plate with the mounted screw units/spring units has to be exchanged in order to convert the system joint.
- The production technique for reinforcing the orthosis as well as the assembly/lamination dummy are identical.

*Note: The converted system ankle joints do not have the same stops as directly acquired NEURO SWING-CLASSIC, NEURO CLASSIC-SWING, NEURO CLASSIC and NEURO CLASSIC-SPRING system ankle joints, as the system stirrups are different.*

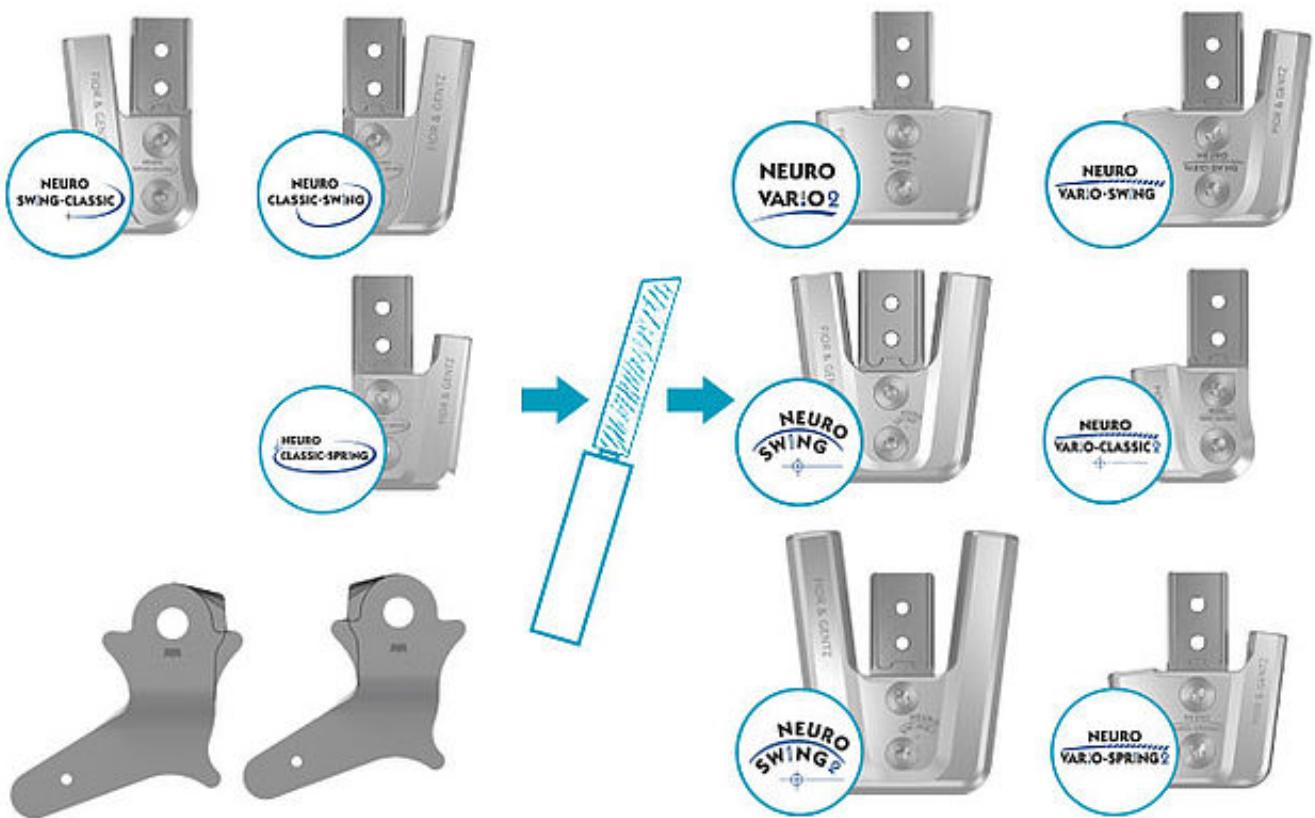

- It is also possible to convert the partially modular system ankle joints NEURO SWING-CLASSIC, NEURO CLASSIC-SWING and NEURO CLASSIC-SPRING into the completely modular system ankle joints NEURO VAR:O 2, NEURO VAR:O-CLASSIC 2, NEURO SWING, NEURO SWING 2, NEURO VAR:O-SWING and NEURO VAR:O-SPRING 2 after filing the system stirrup.
- They differ in the cover plate with the mounted screw units/spring units and in the system stirrup.
- The cover plate with the mounted screw units/spring units has to be exchanged and the system stirrup has to be filed in order to convert the system joint.
- The production technique for reinforcing the orthosis as well as the assembly/lamination dummy are identical.



To assemble the system ankle joints, please refer to the [Joint Assembly Modular System Ankle Joints](#).

**FIOR & GENTZ**

Gesellschaft für Entwicklung und Vertrieb  
von orthopädietechnischen Systemen mbH

Dorette-von-Stern-Straße 5  
21337 Lüneburg

☎ +49 4131 24445-0  
☎ +49 4131 24445-57

✉ info@fior-gentz.de  
🌐 www.fior-gentz.de



## FIOR & GENTZ

Gesellschaft für Entwicklung und Vertrieb von orthopädietechnischen Systemen mbH

Dorette-von-Stern-Straße 5  
D-21337 Lüneburg

Tel.: [+49 4131 24445-0](tel:+494131244450)  
Fax: [+49 4131 24445-57](tel:+4941312444557)  
E-Mail: [info\(at\)fior-gentz.de](mailto:info(at)fior-gentz.de)

## Beratung und Technischer Support

[Verkauf im Innendienst](#)

[Verkauf im Außendienst](#)

[Technischer Support](#)

[Export](#)



### FIOR & GENTZ

Gesellschaft für Entwicklung und Vertrieb  
von orthopädietechnischen Systemen mbH

Dorette-von-Stern-Straße 5  
21337 Lüneburg

☎ [+49 4131 24445-0](tel:+494131244450)  
☎ [+49 4131 24445-57](tel:+4941312444557)

✉ [info@fior-gentz.de](mailto:info@fior-gentz.de)  
🌐 [www.fior-gentz.de](http://www.fior-gentz.de)





